



---

# Arc Court, Maxwell Road, Romford RM7 0FH

£235,000 Leasehold

Modern One Bedroom Apartment for rent in Arc Court, Romford

---

## Description

Docklands Prestige Residential are delighted to offer a modern One Bedroom apartment for sale in Arc Court Reflections.

The property benefits from:

- Double Bedroom
- Open plan kitchen with integrated appliances
- Spacious open plan living space
- Balcony
- Family bathroom
- Close to Local Amenities

The property is fantastically located and a stone's throw from Romford Brewery; The shopping and leisure centre sits at the heart of Romford and is home to many cafes, restaurants, shops, a 16 screen Vue Cinema and even a state of the art Virgin Active Gym. The Brewery is a fun and vibrant place for all ages and easily accessible by car and all forms of public transport.

## Tenure

Leasehold



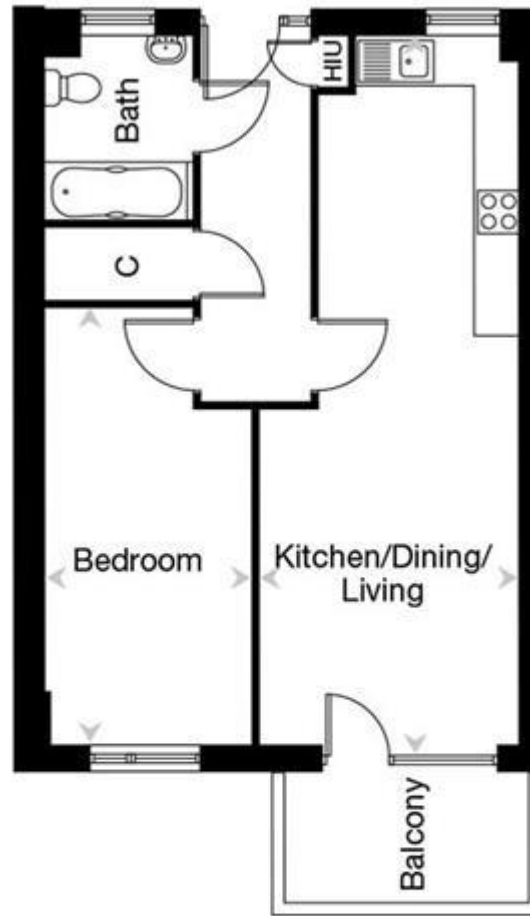

**Kitchen/Living/Dining Area**

8.54m x 3.21m

28'0" x 10'6"

**Bedroom**

5.26m x 2.52m

17'3" x 8'3"



Energy Efficiency Rating		
	Current	Potential
Very energy efficient - lower running costs		
(92-100) <b>A</b>		
(81-91) <b>B</b>	<b>81</b>	
(69-80) <b>C</b>		
(55-68) <b>D</b>		
(39-54) <b>E</b>		
(21-38) <b>F</b>		
(1-20) <b>G</b>		

Viewing by appointment only  
 Docklands Prestige Residential - Head Office  
 Unit F45, Water Front Studios, 1 Dock Road, London E16 1AH  
 Tel: 020 7511 6311 Email: [info@we-are-dpr.com](mailto:info@we-are-dpr.com) Website: <http://we-are-dpr.com>